

# Bioring

A smart design

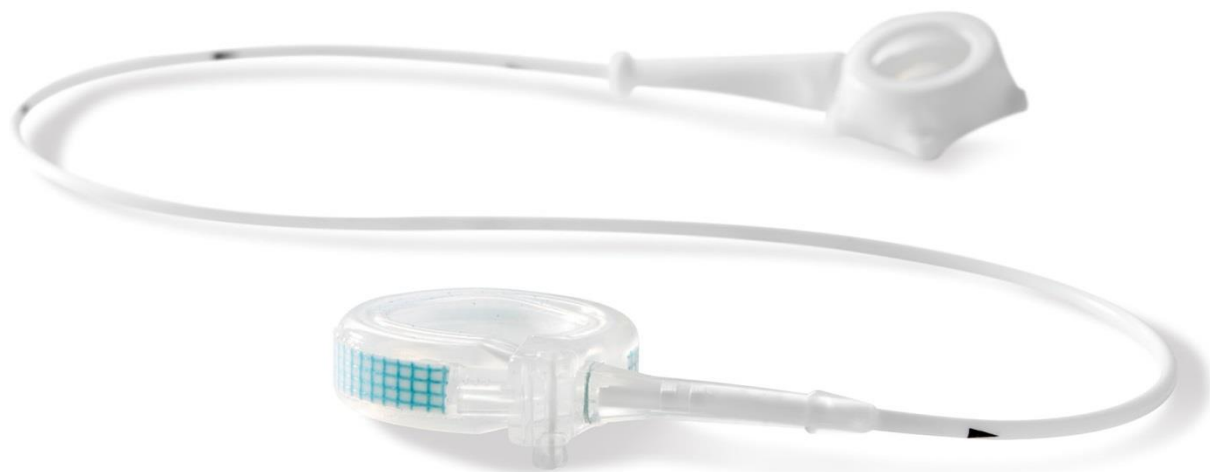

# A complete range: 3 sizes



Band length:

- **S:** 7,3 cm
- **M:** 7,9 cm
- **XL:** 11 cm

# The band

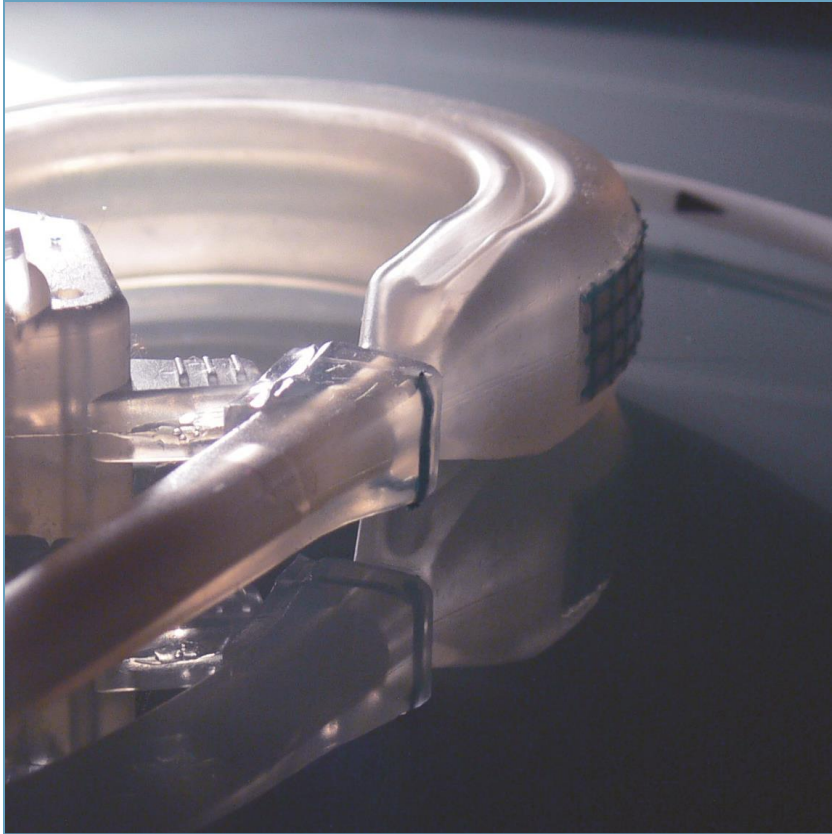

- Soft silicone & **streamlined**: a-traumatic
- **Preshaped**: easy to place
- Transparent & non-white: no flash effect
- Fits in a **12** mm trocar
- Radio-opaque

# Inflation: patented « bellow » system

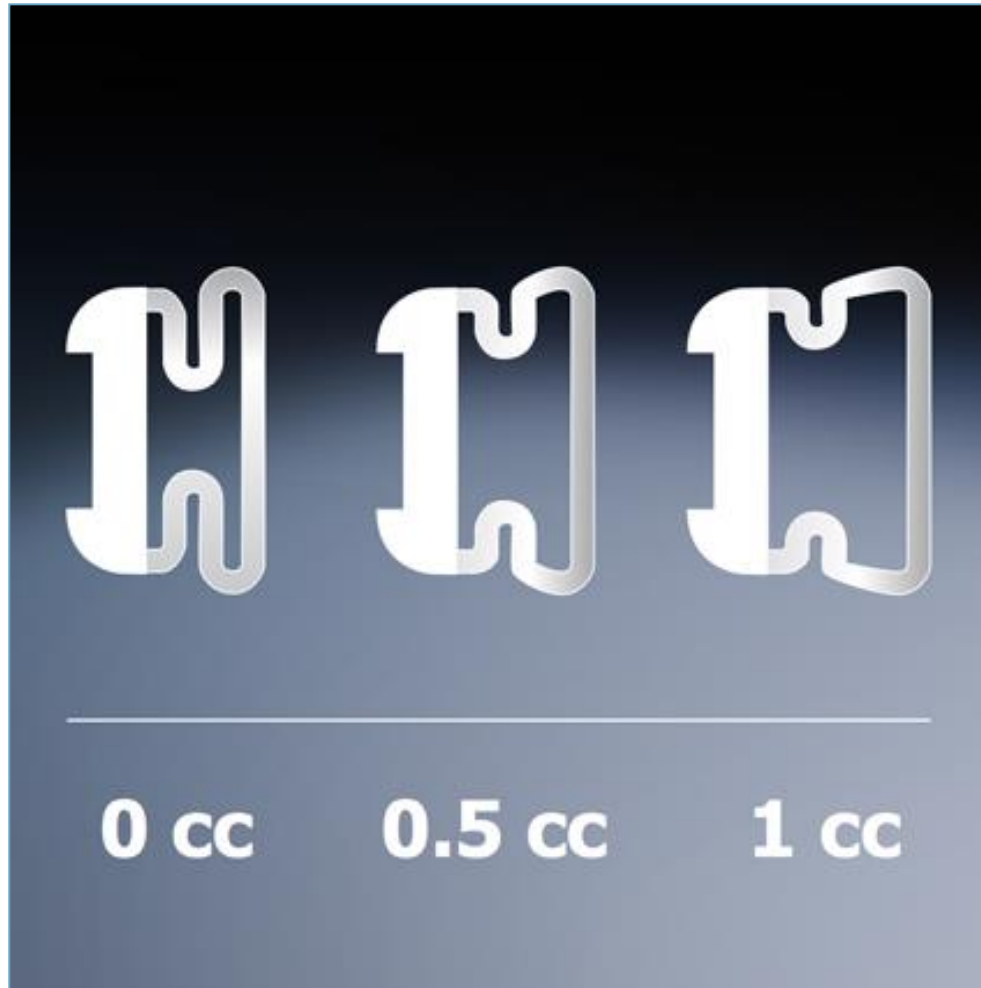

- Keeps large surface in contact with stomach
- Silicone is not stretched: keeps its natural adhering feature
- The bellow follows the stomach's movement: shock absorber and avoids slippage

# Low pressure band

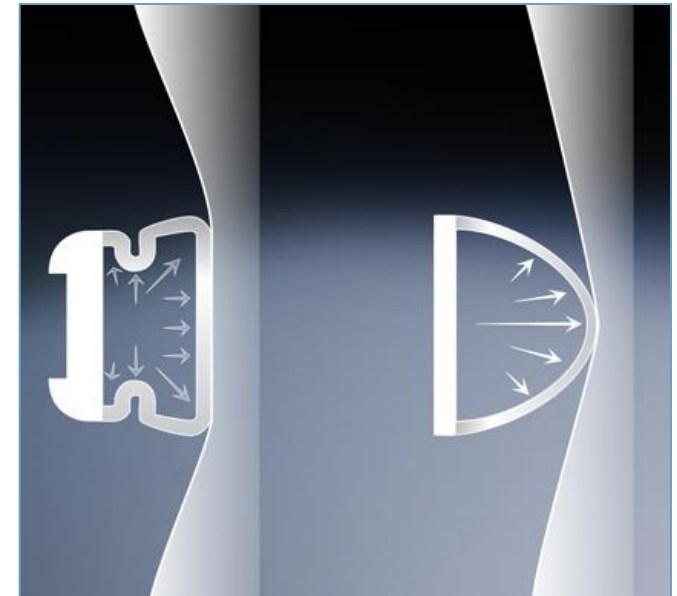
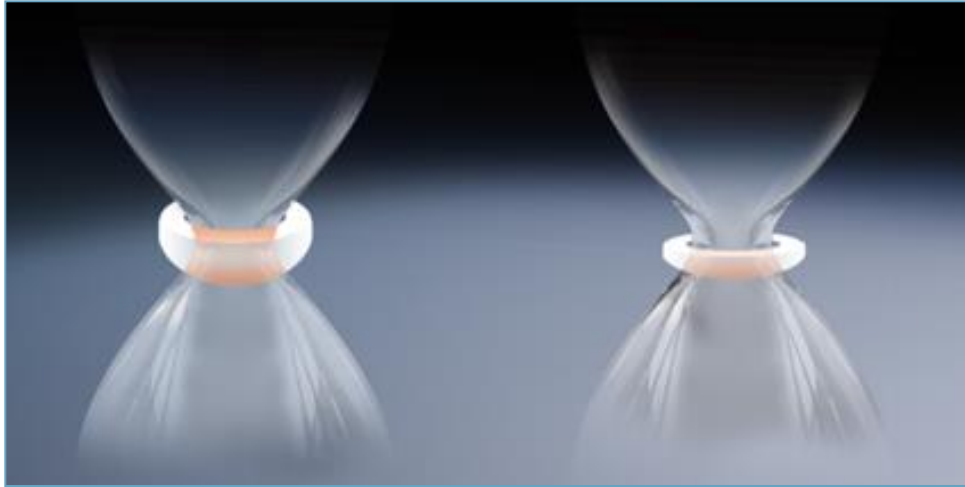

- Pressure is spread over a larger surface
- Band puts less pressure on the stomach wall: it is a low pressure band

# Round angles



- No pinching of the stomach
- No rough angles for the stomach nor the silicone
- Avoid rubbing

# Bioring: designed to prevent complications

- **Prevent erosions**
  - Soft and atraumatic silicone
  - Flexible and preshaped: trauma-free passage in the narrow retro-gastric tunnel
  - Round angles: avoid rubbing effect
- **Prevent slippage**
  - Low pressure band (little pressure on the stomach wall)
  - Good natural adherence (silicone is not stretched)
  - Bellows: shock absorbing effect
- **Prevent pouch dilation**
  - Inflation surface spreads smoothly around the stomach
  - Controlled tightening of the band
- **Prevent leakages**
  - Monoblock band

# The port



- Suturing port
- Self-adhesive port
- Stable shape
- Large injection site (septum)
- “Low profile”
- Silicone locking system
- Radio-opaque



# Bioring Port: designed to prevent complications

- **Prevent rotation**
  - Base 34mm Ø
  - Stable pentagonal base
  - 5 fixation points available
- **Prevent leakages**
  - Locking system: avoids leakages due to needle damages
  - Large septum: easy to target the septum, easy puncture
- **Prevent catheter ruptures**
  - Smooth connector end: prevents shearing effect against the catheter
  - Catheter and connector made of smooth silicone: no abrasive rubbing
- **Prevent disconnections**
  - Locking system with triple security
  - Secure click-shut system

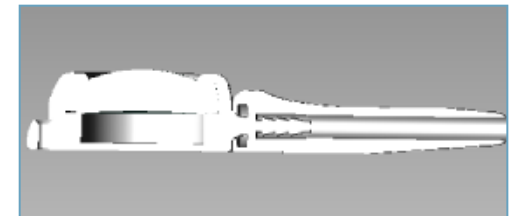

# Product references

## Adhesix® Bioring®

### Gastric band with self-adhesive port

Shape	Product codes	Sizes (cm)	Description
	BCB RI20 AD U	Ø 2,3	Band + Syringe + Catheter rinser + Gripping tab + Self-adhesive Port + Connector + Huber needle
	BCB RI23 AD U	Ø 2,8	
	BCB RIXL AD U	Ø 3,7	

### Replacement kit with self-adhesive port

Shape	Product code	Description
	BCB RIRE AD U	Self-adhesive port + Connector + Huber needle + Catheter + Connector + Obturator + Catheter rinser

One sterile implant per box

## Bioring®

### Gastric band with port to suture

Shape	Product codes	Sizes (cm)	Description
	RINGS 20 000	Ø 2,3	Band + Syringe + Catheter rinser + Gripping tab + Port + Connector + Huber needle
	BCB RI23 PO U	Ø 2,8	
	BCB RIXL PO U	Ø 3,7	

### Replacement kit with port to suture

Shape	Product code	Description
	BCB RIRE PO U	Port to suture + Connector + Huber needle + Catheter + Connector + Obturator + Catheter rinser

One sterile implant per box

## Accessories

Shape	Product codes	Sizes	Description
	RING CATH 00	30 French, length : 1490 mm	Gastric calibration tube

	BCB RIHU BE U	diameter : 0,9 mm / 20G length : 80 mm / 3 1/4 inch	Box of 50 straight Huber needles
--------------------------------------------------------------------------------------	---------------	--------------------------------------------------------	----------------------------------

Sterile Accessories

# Marketing tools

- 3D animation
- Surgical technique video
- Product sheet
- Stomach model with band
- Demo case
- Practical guide for patients after surgery
- Information booklet for patients
- App for patients

